

# Model: WL-LED200

## LEDme® Step Light

WAC®



Fixture Type:

Catalog Number:

Project:

Location:

### PRODUCT DESCRIPTION

Vertical rectangle LEDme® Step Light. Designed for safety and style on stairways, patios, decks, balcony areas, walkways and building perimeters.

Features an architectural design. Energy efficient for long-lasting indoor and outdoor lighting solutions. Creates an attractive, romantic impression at night.

### FEATURES

- 316 marine grade cast stainless steel (SS) available
- Direct wiring, no driver needed
- Title 24 JA8 - 2016 Compliant (120V only)
- Low profile, flush to wall aesthetics with no visible hardware
- 54,000 hour rated life
- Balanced lighting, free of shadows with minimum glare
- Up to 200 fixtures can be connected in parallel
- 5 year WAC Lighting product warranty

### SPECIFICATIONS

**Construction:** Die-cast aluminum or 316 marine grade cast stainless steel

**Power:** Direct wiring, no remote driver needed. Input voltage: 120V or 277V AC 50/60Hz

**Light Source:** 2700K or 3000K CCT Samsung HV-AC High Power LED, CRI: 85  
Optional color lenses. Total power consumption of 3.5W

**Mounting:** Fits into 2" x 4" J-Box with minimum inside dimensions of 3"L x 2"W x 2"H Includes bracket for J-Box mount.

**Dimming:** Dim to 10% with electronic low voltage (ELV) dimmer  
Approved dimmers: Lutron Nova-T NTELV-300 & NTELV-600, Lutron Vietri VTELV-600, Lutron Diva DVELV-300P, Lutron Skylark SELV-300P, Lutron Maestro MAELV-600

**Standards:** IP66, UL & cUL Listed for wet locations, Title 24 Compliant (120V only)

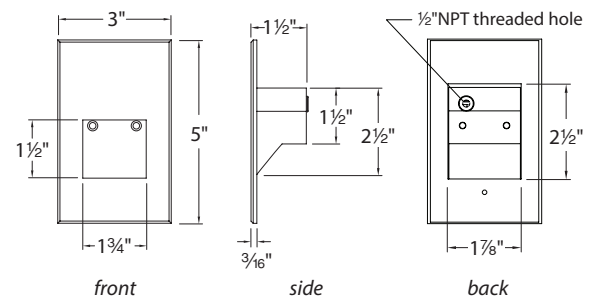

### ORDER NUMBER

| Model #               | Color                 | Finish                    |
|-----------------------|-----------------------|---------------------------|
| <b>WL-LED200</b> 120V | <b>27</b> Warm 2700K  | <b>BK</b> Black           |
|                       | <b>C</b> White 3000K  | <b>BN*</b> Brushed Nickel |
|                       | <b>AM</b> Amber 610nm | <b>BZ</b> Bronze          |
|                       | <b>RD</b> Red 640nm   | <b>GH</b> Graphite        |
|                       | <b>BL</b> Blue 450nm  | <b>SS</b> Stainless Steel |
|                       |                       | <b>WT</b> White           |

| Model #                | Color                 | Finish                    |
|------------------------|-----------------------|---------------------------|
| <b>WL-LED200F</b> 277V | <b>C</b> White 3000K  | <b>BK</b> Black           |
|                        | <b>AM</b> Amber 610nm | <b>BN*</b> Brushed Nickel |
|                        | <b>RD</b> Red 640nm   | <b>BZ</b> Bronze          |
|                        | <b>BL</b> Blue 450nm  | <b>GH</b> Graphite        |
|                        |                       | <b>SS</b> Stainless Steel |
|                        |                       | <b>WT</b> White           |

\*Brushed Nickel Finish is for interior use only



Example: **WL-LED200F-AM-BZ**

wacighting.com  
Phone (800) 526.2588  
Fax (800) 526.2585

Headquarters, East Manufacturing Facility  
44 Harbor Park Drive  
Port Washington, NY 11050

South East Manufacturing Facility  
1600 Distribution Ct  
Lithia Springs, GA 30122

Central Manufacturing Facility  
1700 South J Elmer Freeway, Ste 100  
Cedar Hill, TX 75104

West Manufacturing Facility  
1750 S Archibald Ave  
Ontario, CA 91761